



Freezeless Yard Hydrant

Model X34

X34 hydrants are used for filling field spray equipment, cleaning tools and equipment, lawn and garden care, watering livestock, fire protection - immediate water flow even in sub-zero temperatures.

Features:

One Piece Variable Flow Plunger - Large cushion type seal for longer life - is not easily damaged and assures shut-off even when foreign particles are present.

Maintenance & Repair - Can be accomplished from top of unit without excavating.

Tamper Proof Lock - Can be locked in closed position by inserting padlock or bolt through hole in link.

Long Life Packing - Graphite packing for lubricity and long life.

Long Life Valve Seat - Special shape - large contact area - eliminates need for renewable nylon seat.

Specifications:

Female Inlet: 3/4" NPT

Casing: 1" Galvanized Steel Pipe

Operating Rod: 3/8" Steel Rod

Drain Hole: Tapped - 1/8" N.P.T.

Removable Nozzle: 3/4" Brass Male Hose Nozzle

Maximum Working Pressure: 125 p.s.i.

Maximum Temperature: 120° F



Rough-In Dimensions

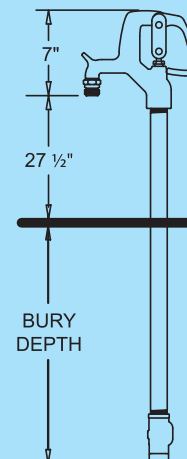

SHIPPING WEIGHT

Bury Depth (Ft)	1	2	3	4	5	6	7*
Shipping Wt. (Lbs)	14	16	18	20	22	24	26

*Must ship by truck line due to length.

When ordering, specify model and bury depth.



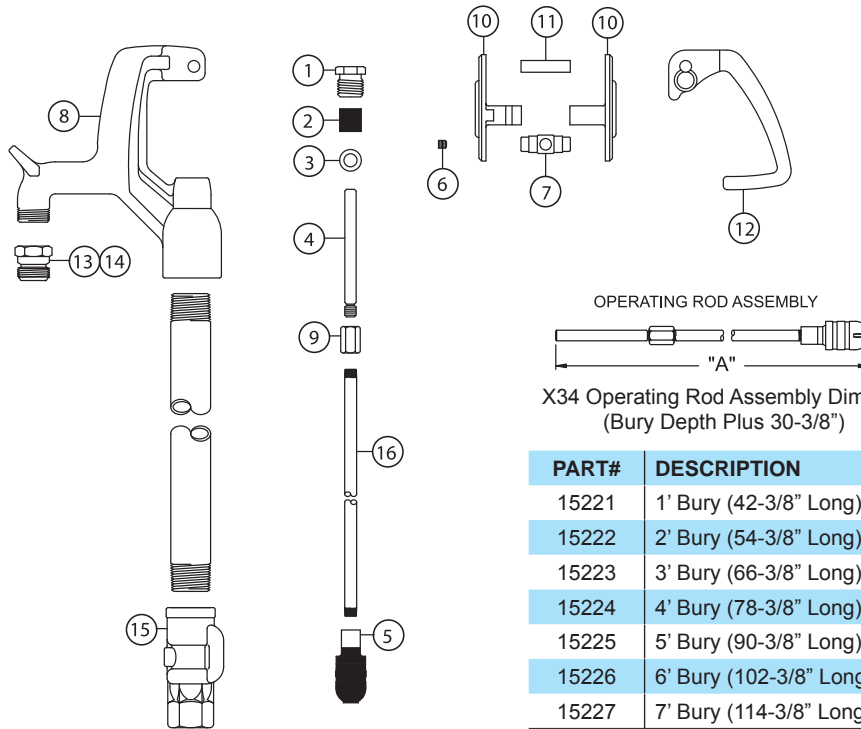

OPERATING ROD ASSEMBLY
 "A"
 X34 Operating Rod Assembly Dim. "A"
 (Bury Depth Plus 30-3/8")

PART#	DESCRIPTION
15221	1' Bury (42-3/8" Long)
15222	2' Bury (54-3/8" Long)
15223	3' Bury (66-3/8" Long)
15224	4' Bury (78-3/8" Long)
15225	5' Bury (90-3/8" Long)
15226	6' Bury (102-3/8" Long)
15227	7' Bury (114-3/8" Long)

MODEL X34 PARTS LIST

ITEM	PART#	DESCRIPTION	ITEM	PART#	DESCRIPTION
	15037	Head Assembly - Complete (Includes Items 1-4, 6-13)	16	X34 - 3/8" Operating Rod (Bury Depth & Length)	
1	10100	Packing Nut		10471	1' Bury (36-11/16" Long)
2	10101	Packing		10472	2' Bury (48-11/16" Long)
3	10102	Packing Support Washer		10473	3' Bury (60-11/16" Long)
4	10104	Brass Rod Stem		10474	4' Bury (72-11/16" Long)
5	10108	Plunger		10475	5' Bury (84-11/16" Long)
	15050	Pivot Assembly (Includes Items 6 & 7)		10476	6' Bury (96-11/16" Long)
6	10158	Pivot Set Screw		10477	7' Bury (108-11/16" Long)
7	10159	Pivot		RK-X34	Repair Kit (Includes Items 1-7)
8	15021	Head & Nozzle Assembly (Includes Item 13)		*RK-WXL	Steel Link Repair Kit (Interchangeable with Items 10 & 11)
9	10481	Coupling Nut			
10	*	Links - (Replace with RK-WXL)			
11	10142	Handle Pin			
12	10227	Handle (Blue)			
13	10004	3/4" Brass Hose Nozzle (Standard)			
14	10007	1" Brass Hose Nozzle (Optional)			
15	10018	Valve Body			

For more information contact...

WOODFORD MANUFACTURING COMPANY

2121 Waynoka Road, Colorado Springs, Colorado 80915 • Phone: (800) 621-6032 • Fax: (800) 765-4115
 To view our complete product line visit: www.woodfordmfg.com or email: sales@woodfordmfg.com
 A Division Of WCM Industries, Inc.